

Step 1: Open a NEW DOCUMENT in Photoshop.

Note: **DO NOT** open your Illustrator in Photoshop. We will be **PLACING** it in the next step.

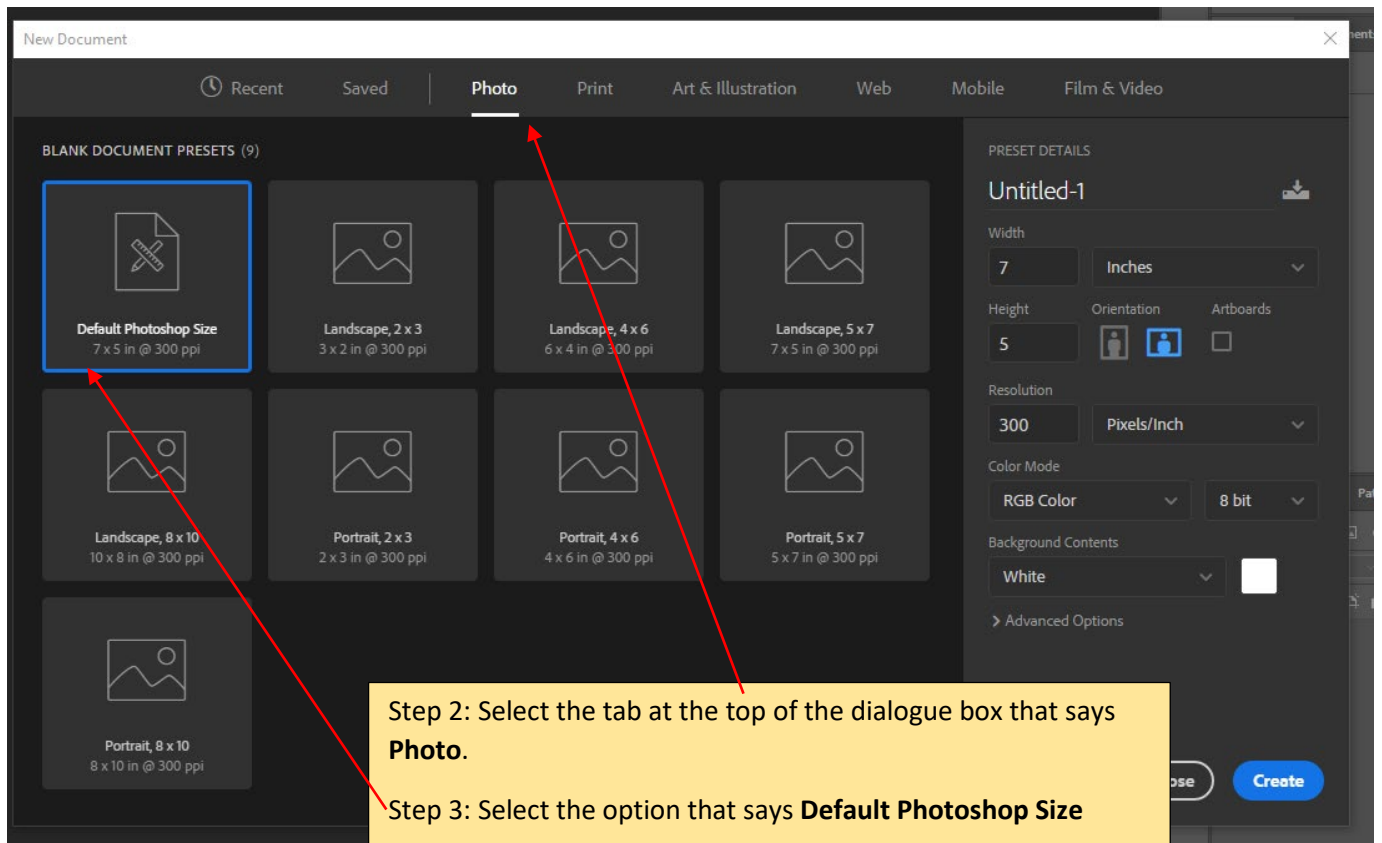

Step 2: Select the tab at the top of the dialogue box that says **Photo**.

Step 3: Select the option that says **Default Photoshop Size**

Step 4: Name your document and then select **Create**

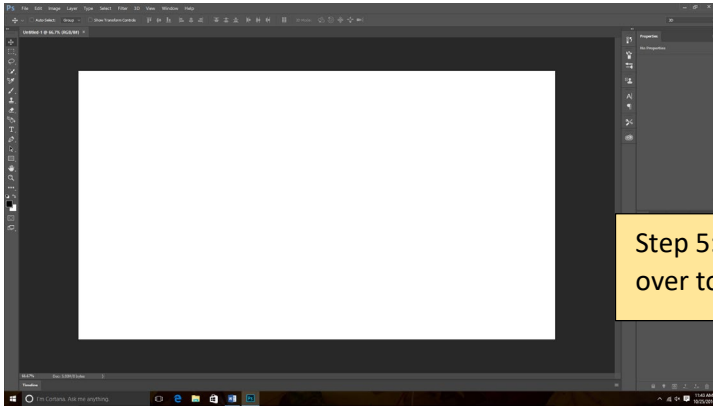

Step 5: Once you see a blank document, hover over to FILE

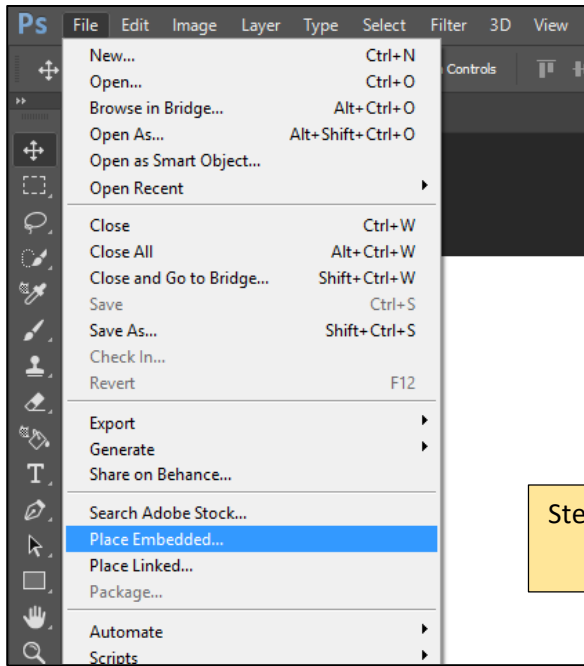

Step 6: Click PLACE EMBEDDED

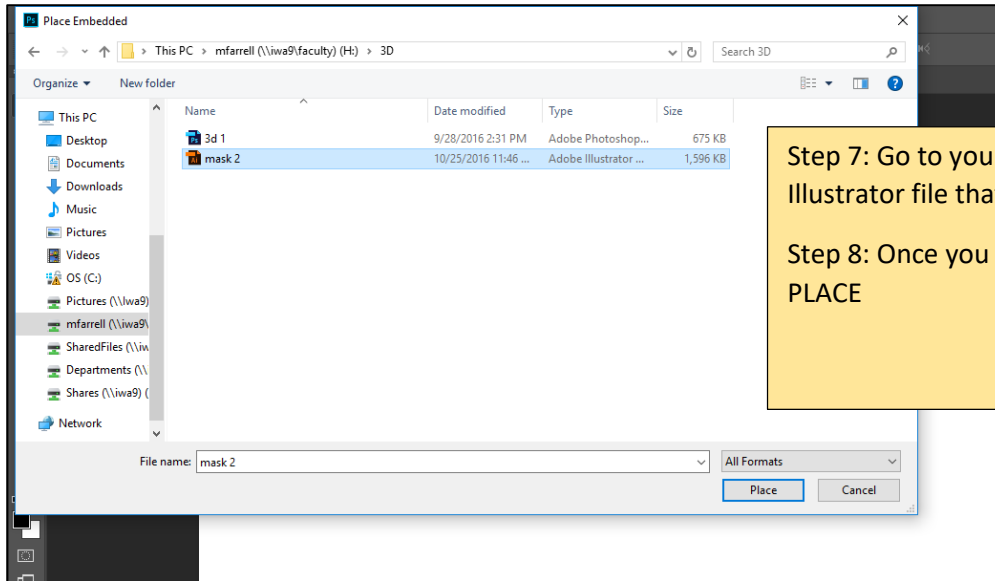

Step 7: Go to your H Drive and find the Illustrator file that you created.

Step 8: Once you find it, select it then click PLACE

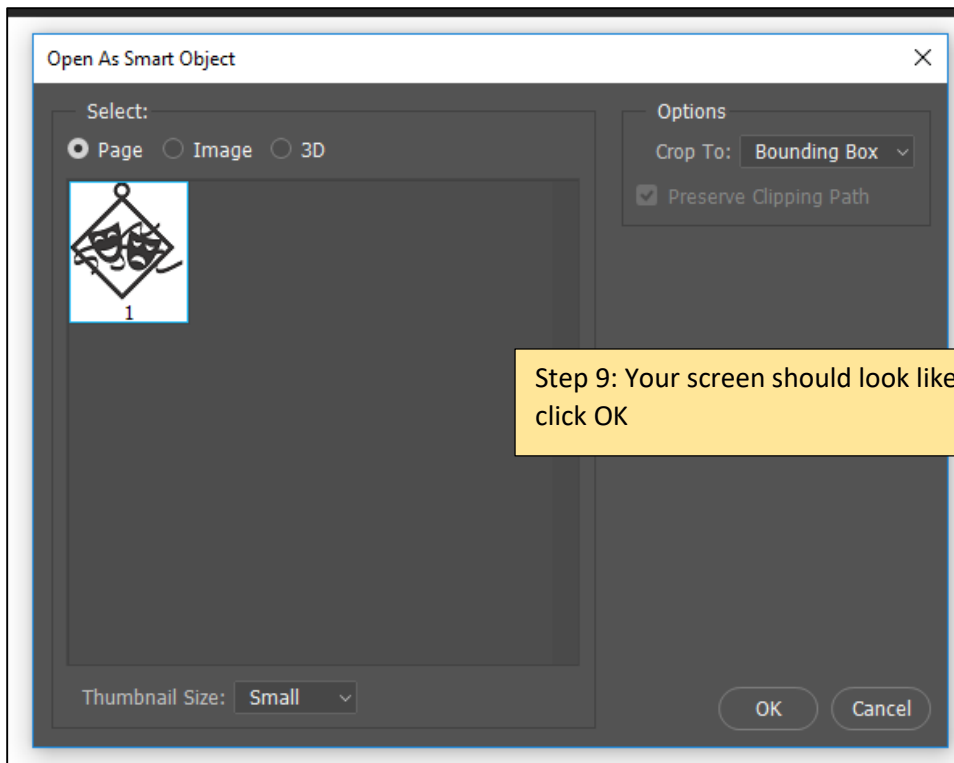

Step 9: Your screen should look like this. If so, click OK

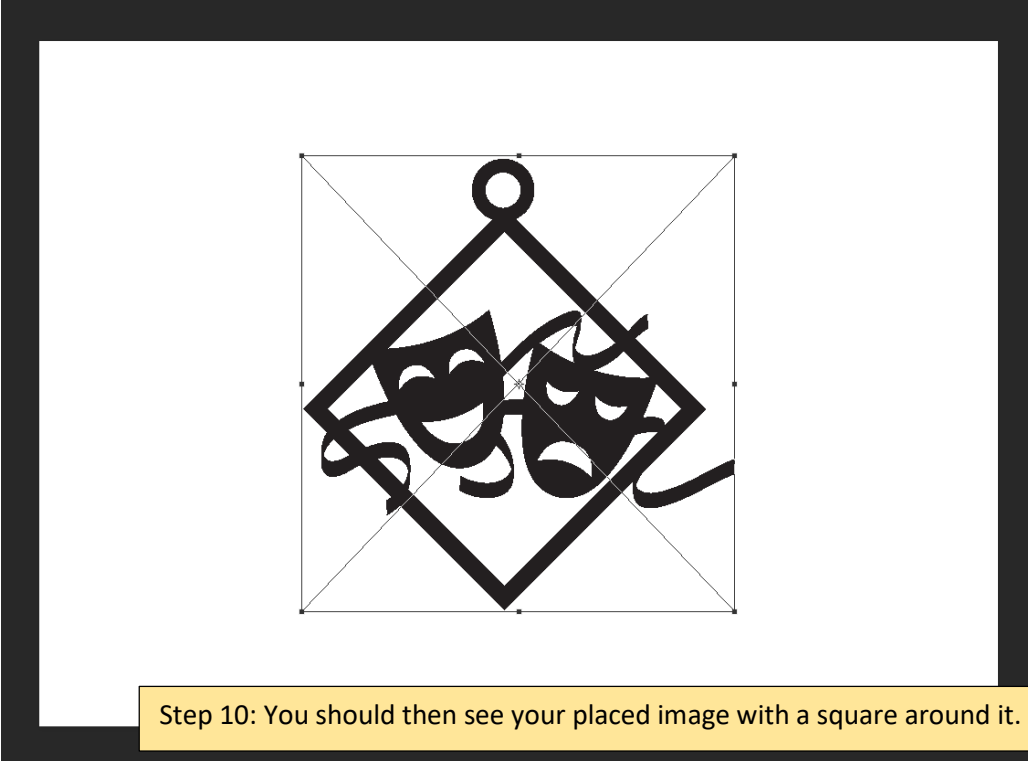

Step 10: You should then see your placed image with a square around it.

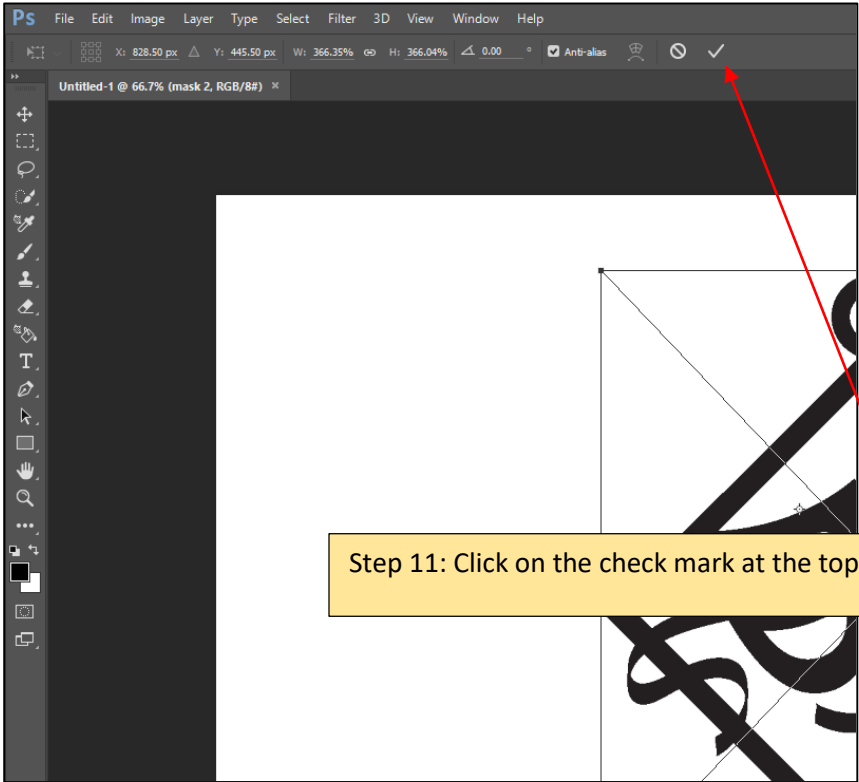

Step 11: Click on the check mark at the top.

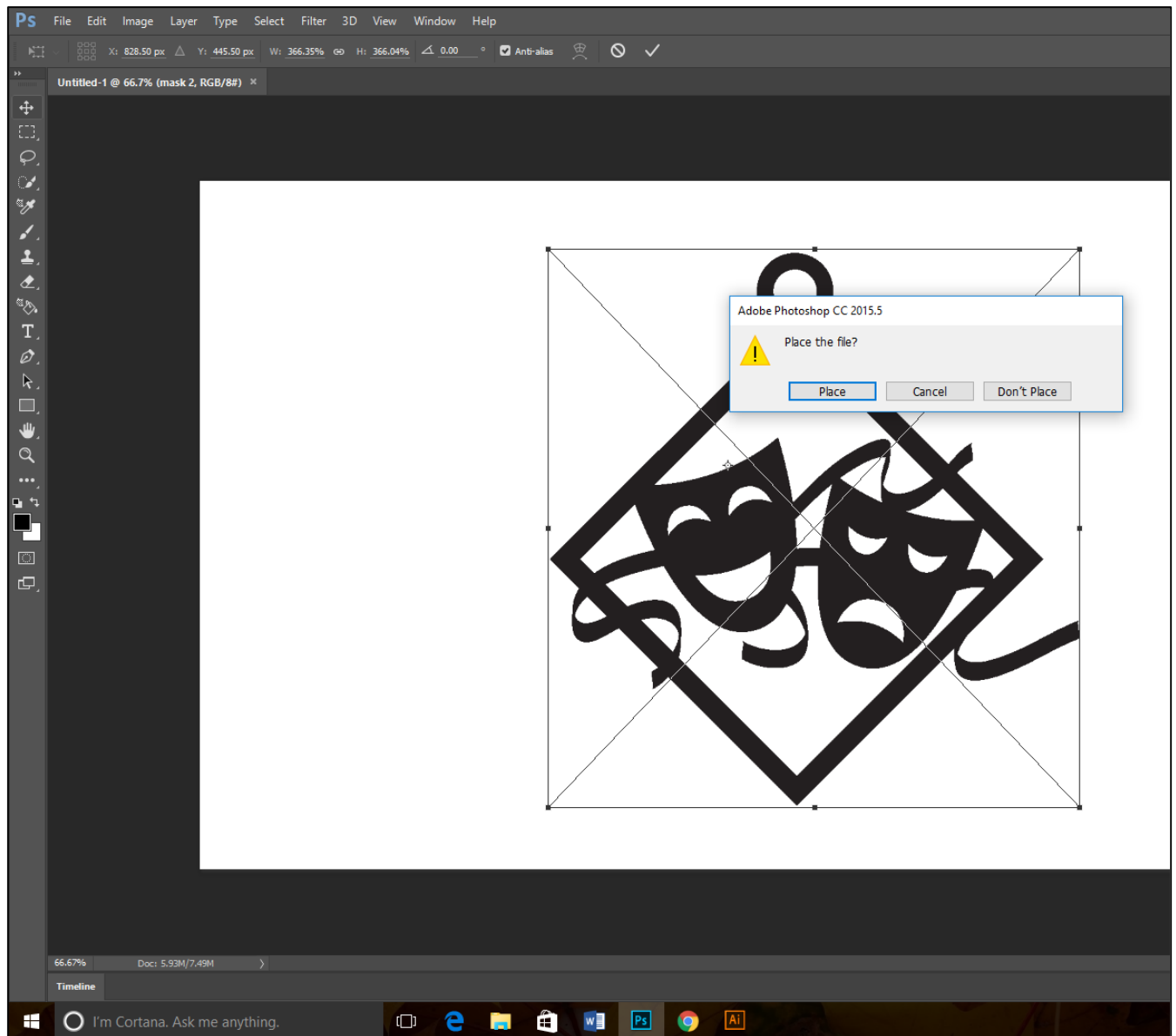

Step 12: Your screen should look like this. If so, click PLACE

Step 13: Hover over to the layers panel on the right, make sure it is selected.

Step 14: Right click on the panel that your image is in (mine is highlighted in the grey right now)

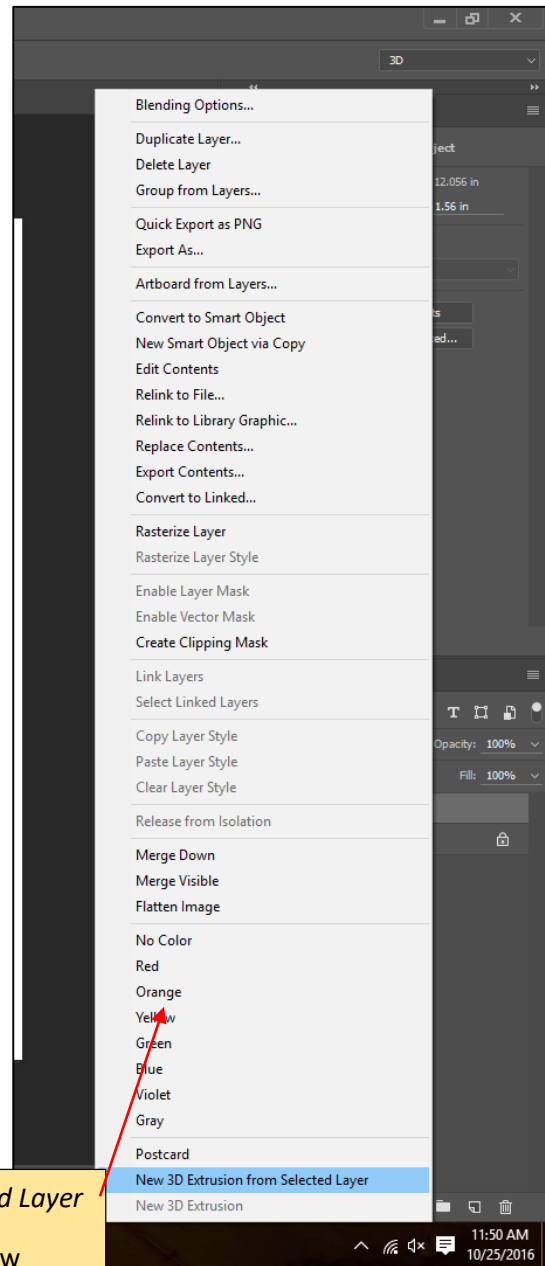
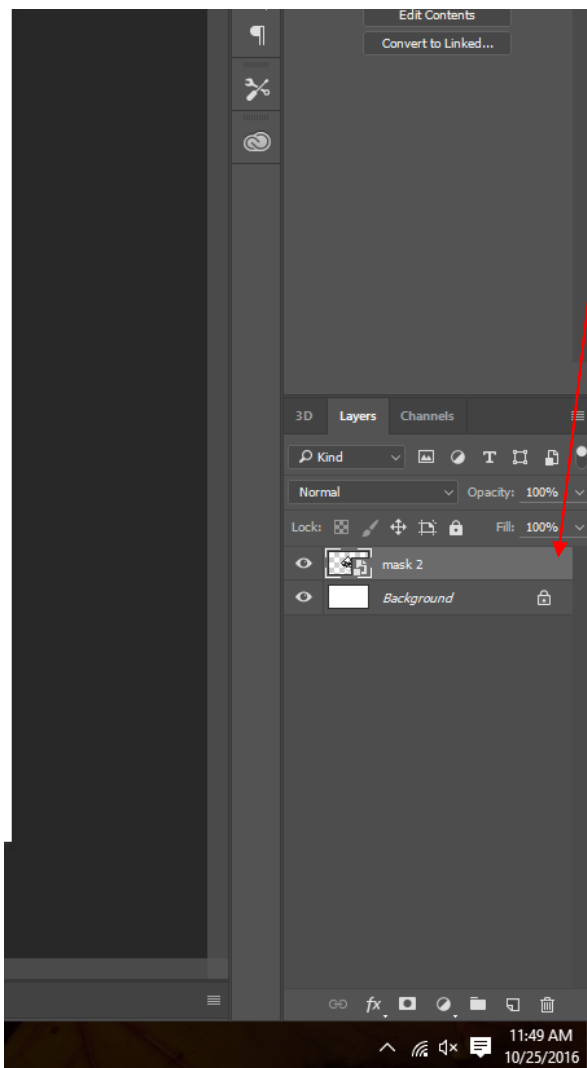

Step 15: Select *New 3D Extrusion from Selected Layer*

Step 16: It may ask you if you would like to view image in 3D Layer, if it asks you this, select YES

(If it automatically creates a 3D Layer, go to step 17)

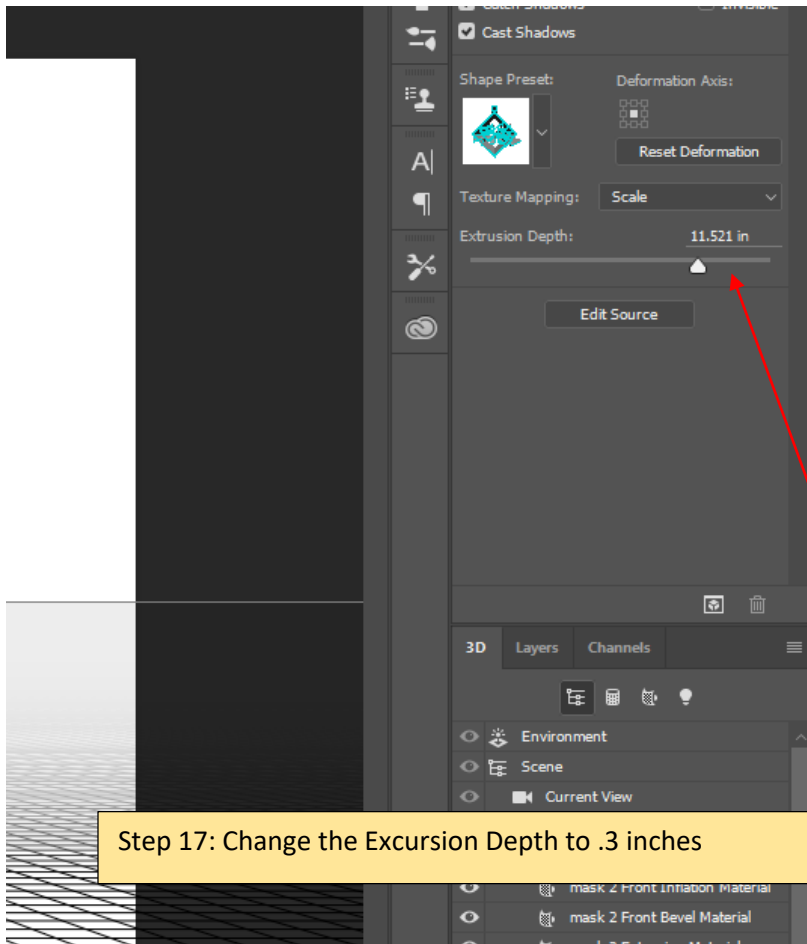
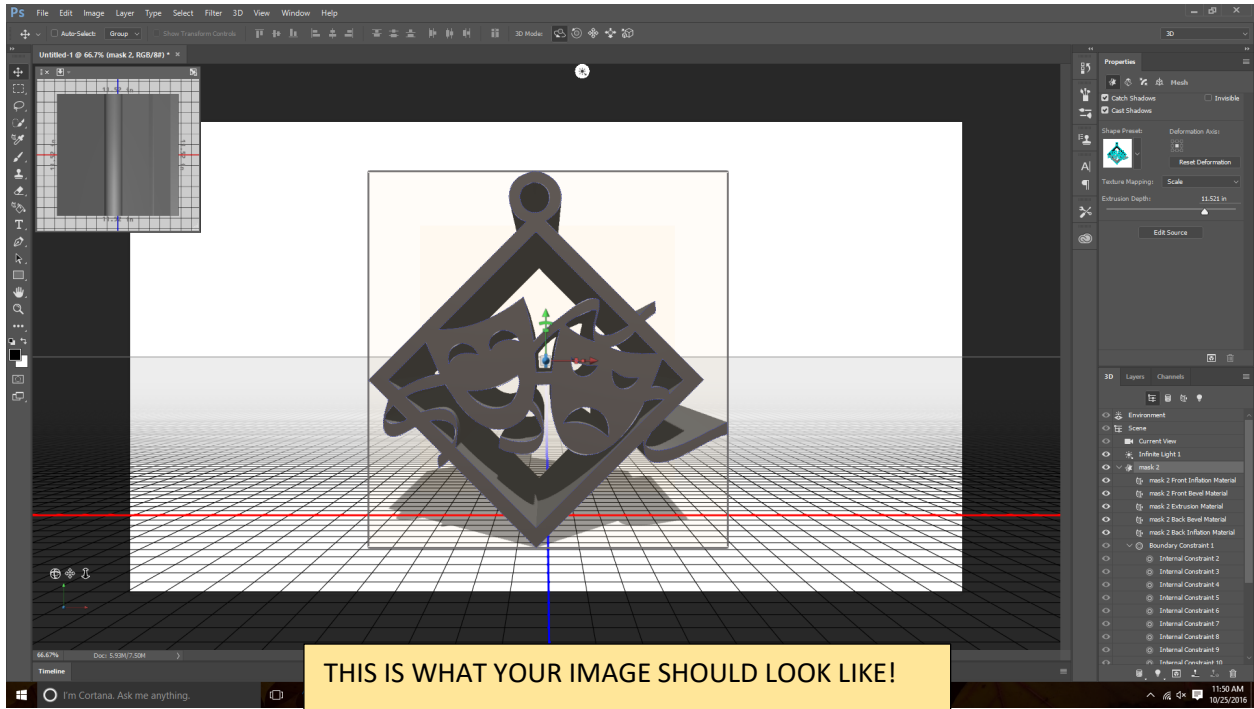

Step 17: Change the Excursion Depth to .3 inches

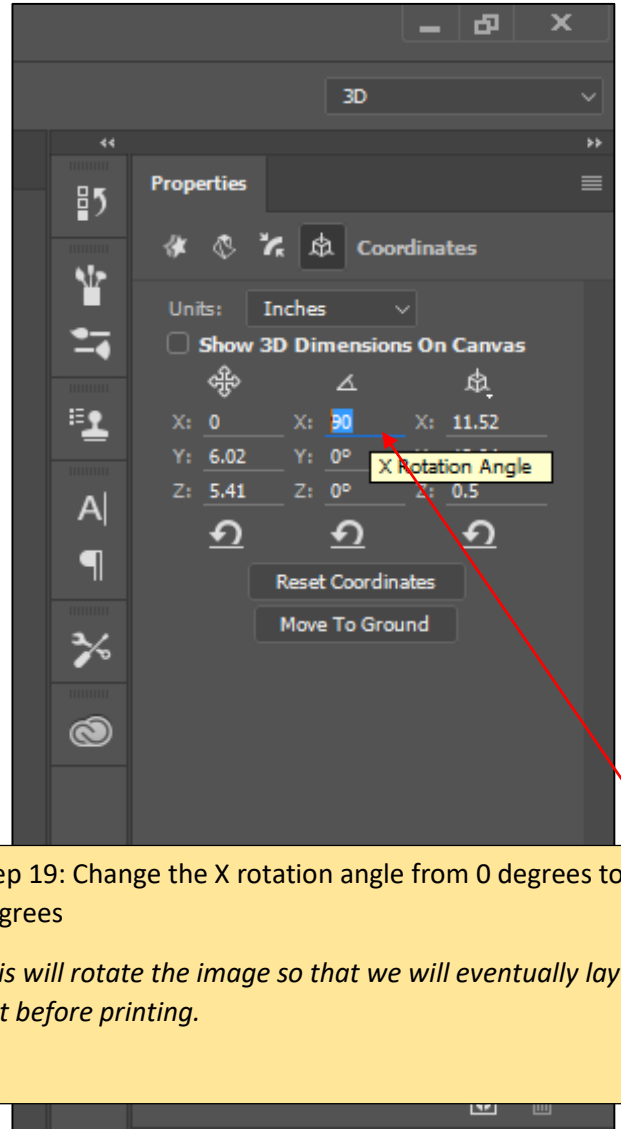
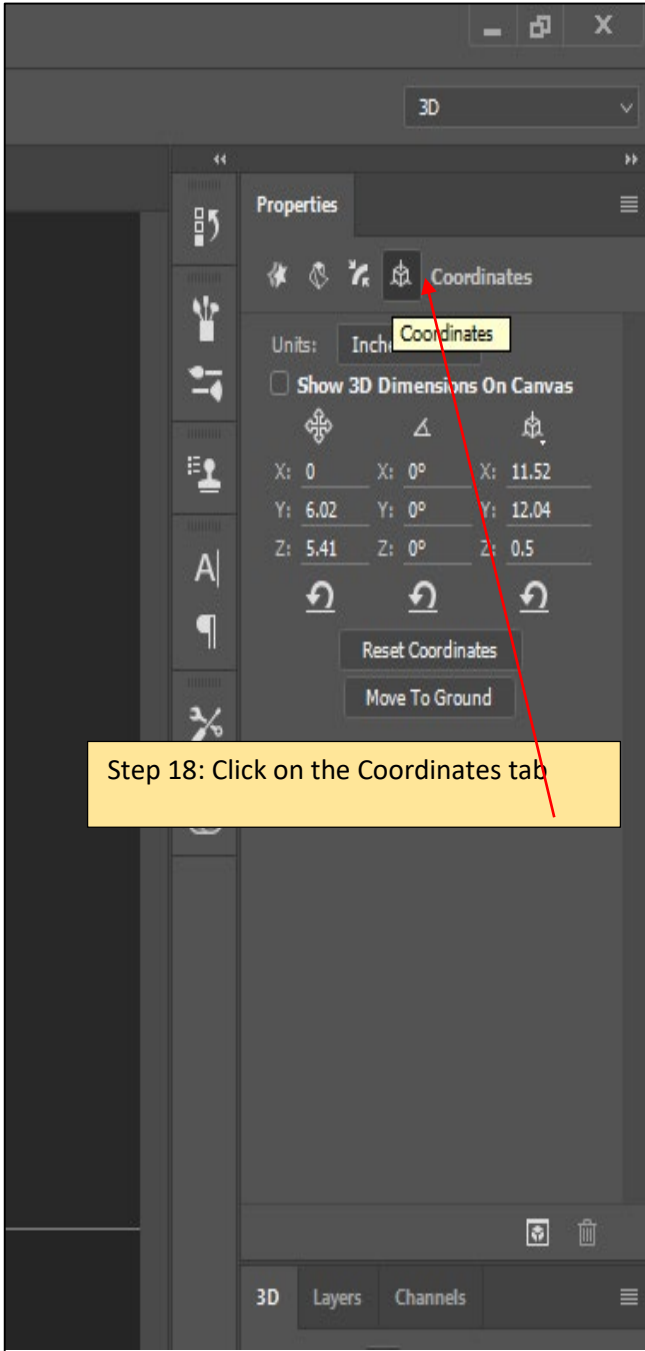



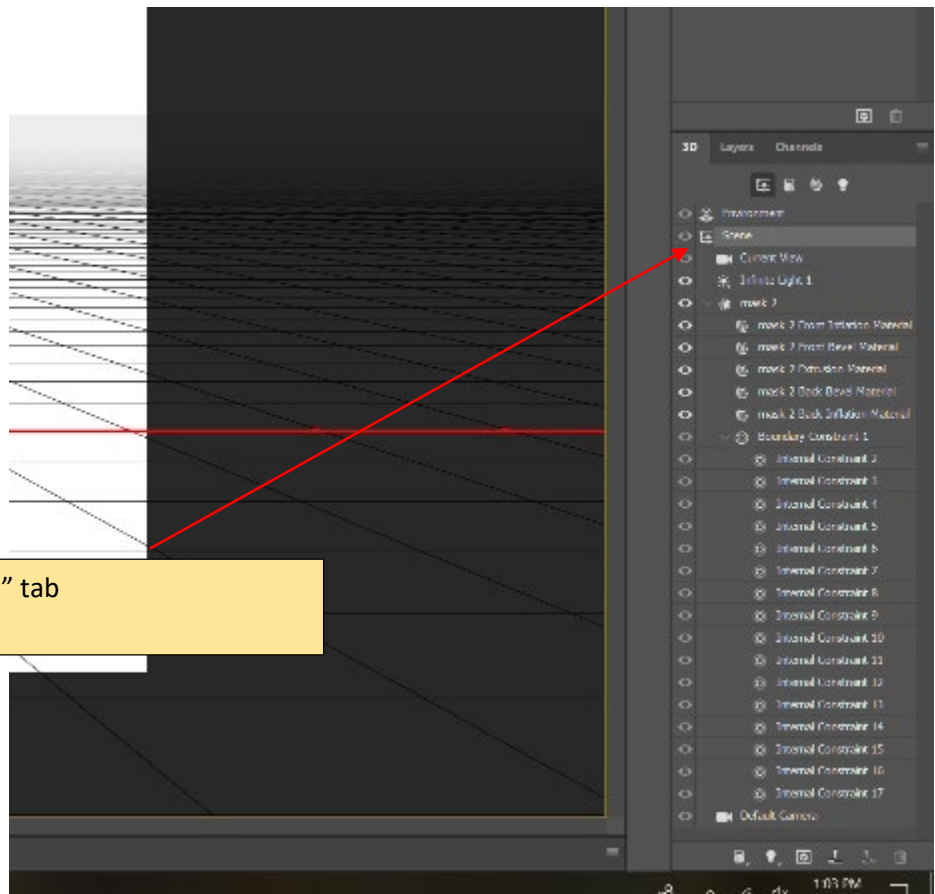

Step 20: Next, click on the "Scene" tab

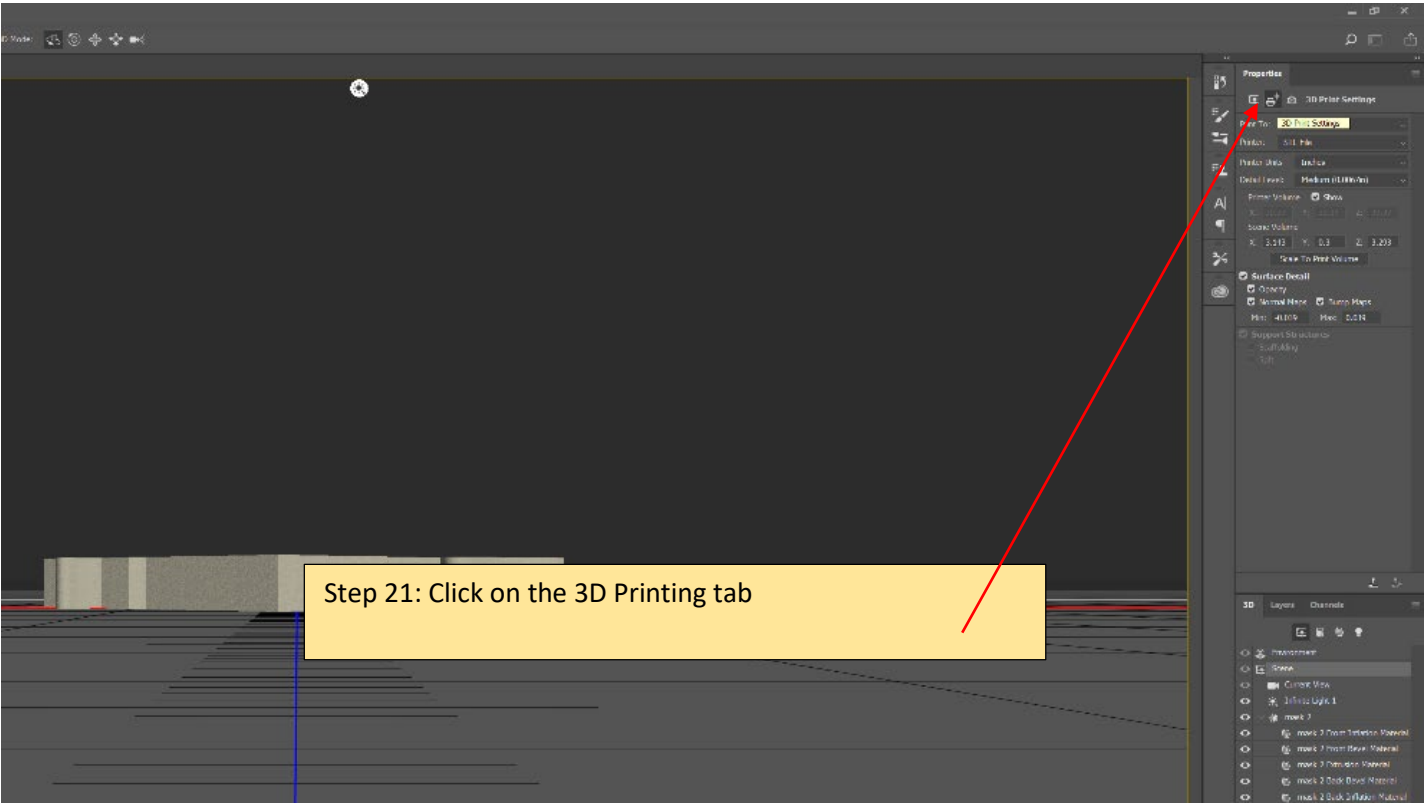

Step 21: Click on the 3D Printing tab

